

- NOTES:**
- DIMENSIONS ARE APPROXIMATE ONLY DUE TO NO TOPOGRAPHICAL SURVEY. DRAWING BASE RECEIVED FROM OTHERS, SURVEY CARRIED OUT BY OTHERS. SUSTRANS CANNOT GUARANTEE THEIR ACCURACY. CONTRACTOR TO SATISFY THEMSELVES AS TO THE ACCURACY OF SUCH INFORMATION.
 - ALL DIMENSIONS IN METRES UNLESS OTHERWISE STATED.
 - DO NOT SCALE FROM ANY DRAWING. WORK TO FIGURED DIMENSIONS ONLY. ANY DISCREPANCIES IN DIMENSION ARE TO BE REFERRED TO THE DESIGNER BEFORE WORK IS PUT TO HAND.
 - ALL DIMENSIONS AND LEVELS ARE TO BE CHECKED ON SITE BY THE CONTRACTOR PRIOR TO PREPARING ANY WORKING DRAWINGS OR COMMENCING ON SITE.
 - ALL WORKS BY THE CONTRACTOR MUST BE CARRIED OUT IN SUCH A WAY THAT ALL REQUIREMENTS UNDER THE HEALTH AND SAFETY AT WORK ACT ARE SATISFIED.
 - ALL WORK IS TO BE CARRIED OUT IN COMPLIANCE WITH THE REQUIREMENTS OF THE STATUTORY AUTHORITIES AND CONSTRUCTION DESIGN AND MANAGEMENT REGULATIONS.

LEGEND

- █ REDIWELD BUS BOARDER PLATFORM (Fig 2)
- █ EXISTING GUARDRAIL TO BE REMOVED
- █ MANDATORY CYCLE LANE ROAD MARKING (EXISTING LINES TO BE REFRESHED)
- █ BOLT DOWN BOLLARD TO BE ERECTED ALONG MANDATORY CYCLE LANE ROAD MARKING AT 9M CENTRES AS SHOWN ON DRAWING (TMP BLACK CITYPOST OR SIMILAR SEE Fig. 1)
- █ 'OPTIONAL' BOLLARD TO BE ERECTED AT 9M CENTRES AS SHOWN ON DRAWING (TMP BLACK CITYPOST OR SIMILAR SEE Fig. 1) - TO BE CONFIRMED BY LOCAL AUTHORITY
- █ ADVISORY LANE ROAD MARKING
- █ EDGE OF EXISTING ROAD
- █ APPROXIMATE DRIVEWAY LOCATION - ORCAS NOT TO BE PLACED OVER DRIVEWAY OR ACCESS POINTS.
- █ INDICATIVE LOCATION OF BUS STOP MARKINGS
- █ CYCLE SYMBOL TO MARKING 1057
- █ PROPOSED REDUCED CENTRAL RESERVE

This map is reproduced from Ordnance Survey material with the permission of Ordnance Survey on behalf of the Controller of Her Majesty's Stationery Office © Crown copyright. Unauthorised reproduction infringes Crown copyright and may lead to prosecution or civil proceedings.
100037194 (2020)

IMPORTANT

HEALTH, SAFETY & ENVIRONMENTAL INFORMATION

IN ADDITION TO THE HAZARDS AND RISKS NORMALLY ASSOCIATED WITH THE TYPE OF WORK DETAILED ON THIS DRAWING, PLEASE NOTE THE FOLLOWING SIGNIFICANT RISKS TO HEALTH & SAFETY:-

THE SIGNIFICANT RISKS ASSOCIATED WITH THE PROJECT ARE NOTED BELOW

Ref: 1 The site specific hazards are highlighted on drawings and identified in designer's hazard register.

REFERENCE RESIDUAL HAZARD REGISTER FOR FULL DETAILS REF: BLR-DRA-12727-1100

IT IS ASSUMED THAT ALL WORKS SHALL BE UNDERTAKEN BY A COMPETENT CONTRACTOR WORKING WHERE APPROPRIATE TO AN APPROVED SAFE SYSTEM OF WORK

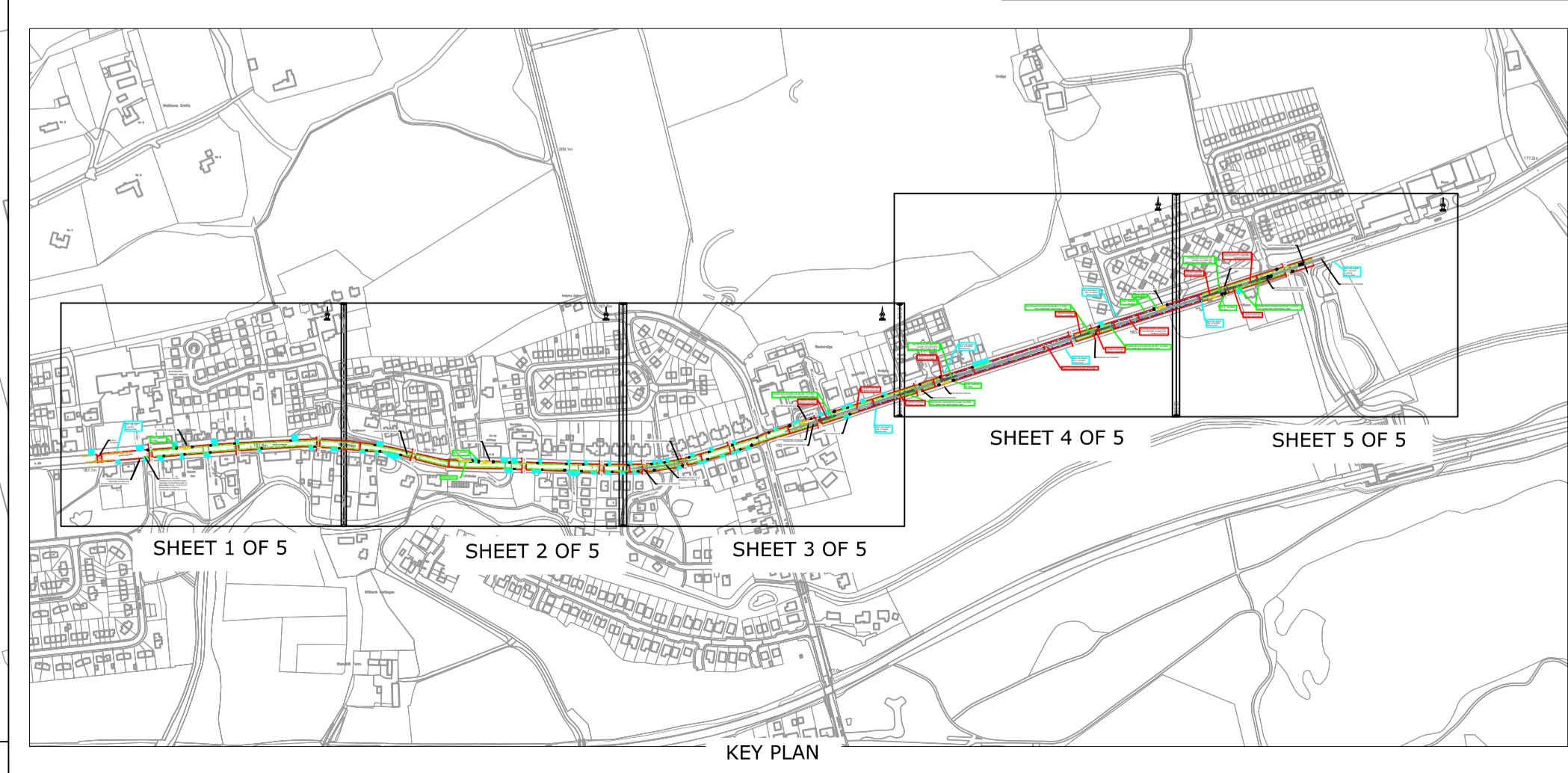

1	Annotation amended	SG	06/10	
2	Road safety audit recommendations added	SG	30/11	
3	Bus platforms removed and cycle lane signs added	SG	30/03/21	

REVISION	DETAILS	BY	DATE	CHECKED
----------	---------	----	------	---------

West Lothian Council
WHSC
North Site
4 Inchmuir Road
Bathgate, EH48 2EP

Operational Services

SPACES FOR PEOPLE
A89 MAIN STREET - BLACKRIDGE
SHEET 3 OF 5

Date: 23/06/2020 Job No.: 636891 Drawn by: CAW
Scale: 1:500 Checked by: