

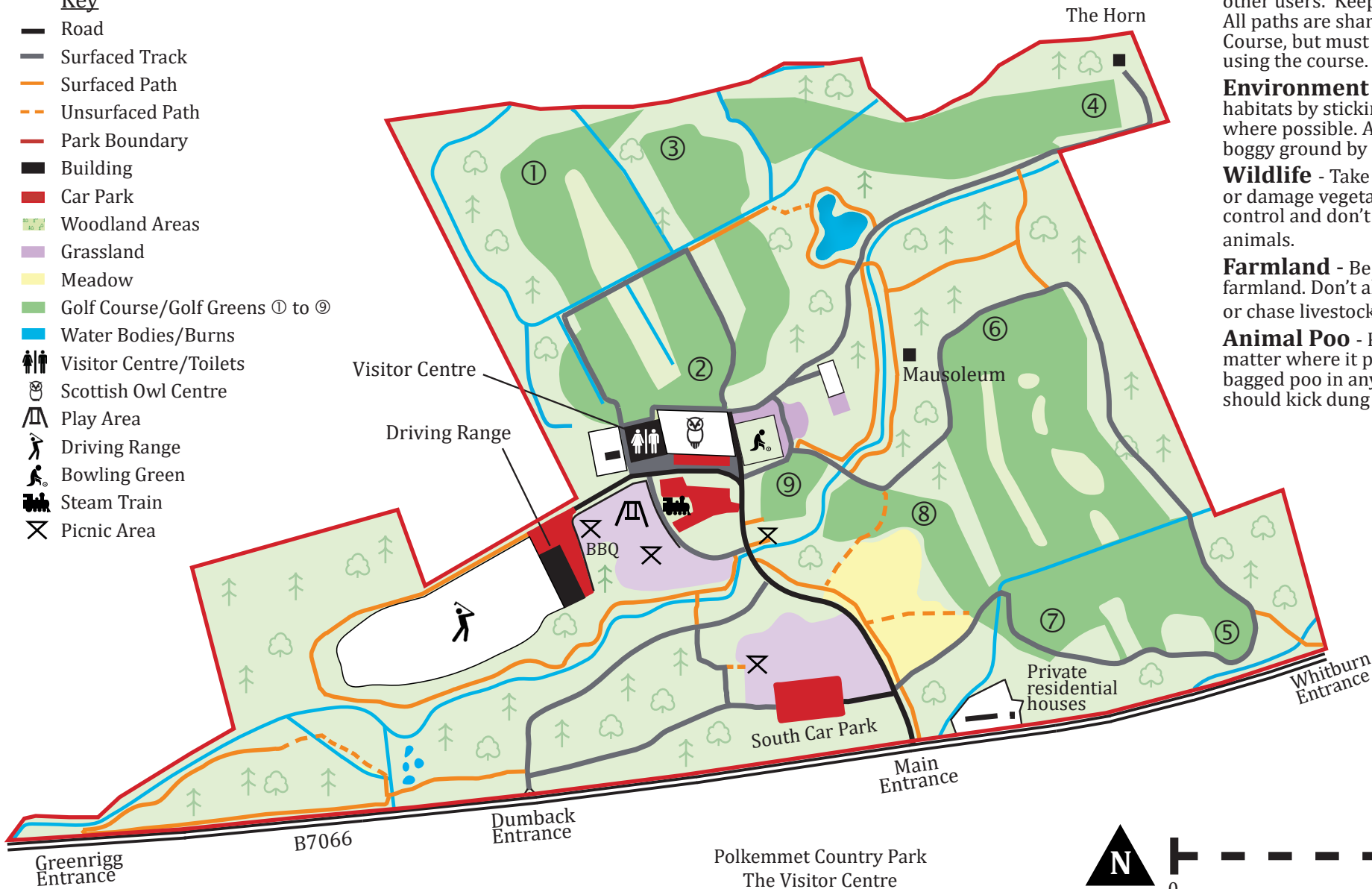

Polkemmet Country Park

Key

- Road
- Surfaced Track
- Surfaced Path
- Unsurfaced Path
- Park Boundary
- Building
- Car Park
- Woodland Areas
- Grassland
- Meadow
- Golf Course/Golf Greens ① to ⑩
- Water Bodies/Burns
- Visitor Centre/Toilets
- Scottish Owl Centre
- Play Area
- Driving Range
- Bowling Green
- Steam Train
- Picnic Area



Scottish Outdoor Access Code:

"You have the right to access providing you act responsibly". At Polkemmet, this means:

Be Aware - Be alert and respectful to other users. Keep your dog under control. All paths are shared. You may access the Golf Course, but must not disrupt play for golfers using the course.

Environment - Avoid causing damage to habitats by sticking to paths and tracks where possible. Avoid churning up wet and boggy ground by using alternative routes.

Wildlife - Take care not to disturb wildlife or damage vegetation. Keep your dog under control and don't let them chase or worry animals.

Farmland - Be aware when near farmland. Don't allow dogs to approach, bark or chase livestock, even through fences.

Animal Poo - Pick up after your dog no matter where it poops. You can put your bagged poo in any litter bin. Horse riders should kick dung off busy paths.

Polkemmet Country Park
The Visitor Centre
Nr. Whitburn EH47 0AD

01501 743905 www.westlothian.gov.uk/polkemmet
mail@beecraigs.com





Polkemmet Country Park Waymarked Routes

Key

- Red Route (approx. 2.3km/35 mins)
- Blue Route (approx. 1.6km/25 mins)
- Road
- Surfaced Track
- Surfaced Path
- Unsurfaced Path
- Park Boundary
- Building
- Car Park
- Woodland Areas
- Grassland
- Meadow
- Golf Course/Golf Greens ① to ⑩
- Water Bodies/Burns
- Visitor Centre/Toilets
- Scottish Owl Centre
- Play Area
- Driving Range
- Bowling Green
- Steam Train
- Picnic Area



Cyclists - slow down and give way to other users



Horse Riders - no galloping in the Park, and kick dung off paths



Walkers - Allow space for other users to pass. Keep dogs under control and pick up after your dog wherever it poops



Golfers have right of way on the course, but should allow other park users time to move themselves from the line of play before taking a shot

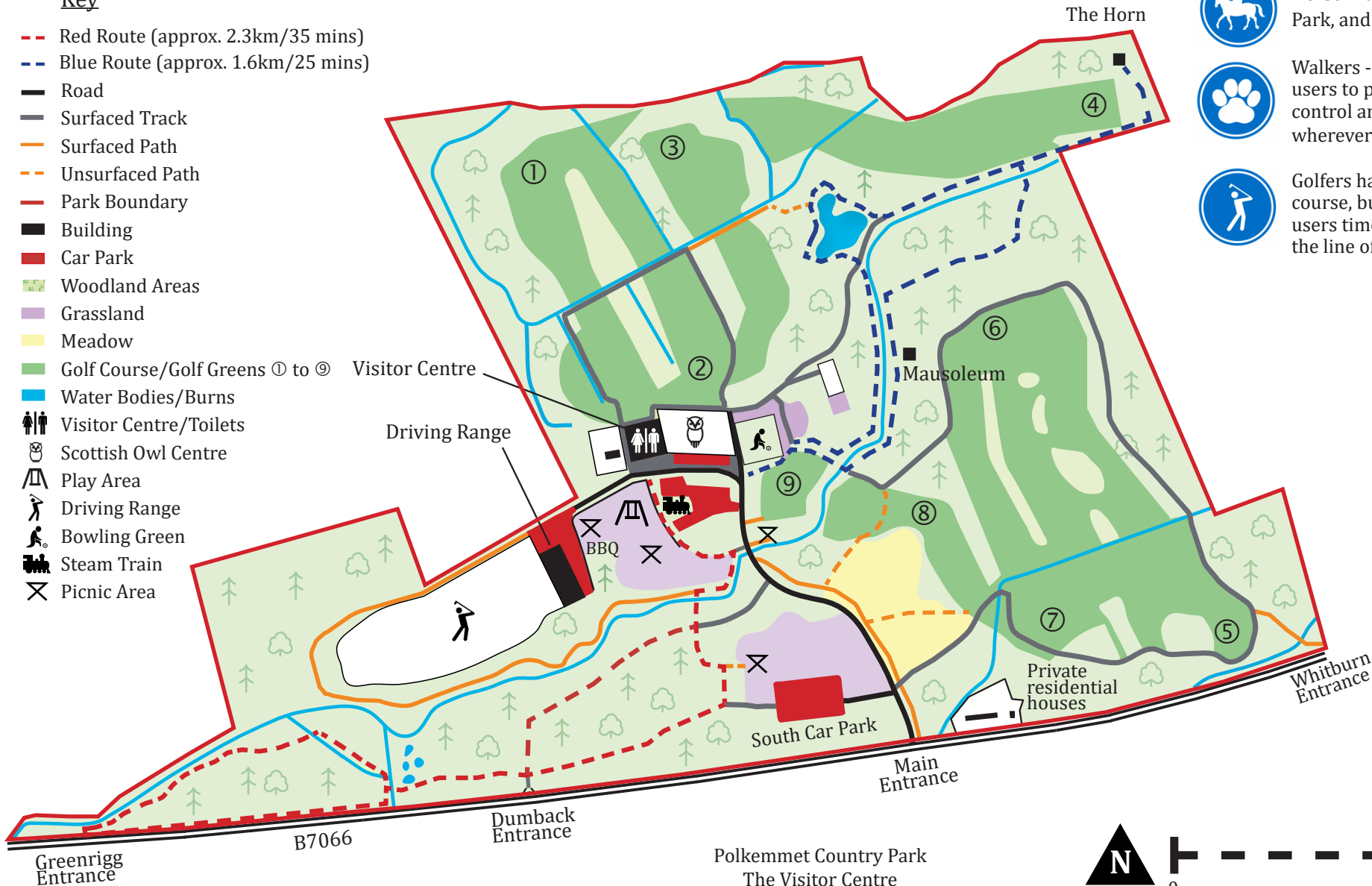

Polkemmet Country Park
The Visitor Centre
Nr. Whitburn EH47 0AD

01501 743905 www.westlothian.gov.uk/polkemmet
mail@beecraigs.com

